



Backing Ring HDPE Pipe

www.smartjoint.net



PP Coated Backing Ring ISO7005/EN1092

Material:PP(30% Glass Fiber Reinforced) With Steel Ring
 UV-resistant. Applicable for outside applications
 Standard:ISO7005,EN1092,BS 4504,DIN 2501

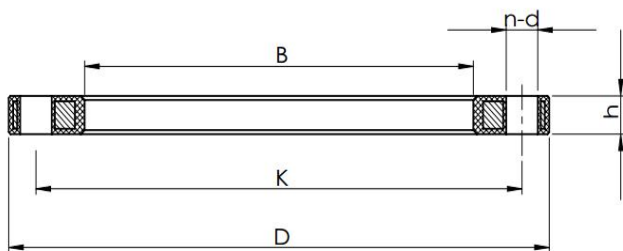

DN	PE dn	PN	D	K(PCD)	B(ID)	n	d	h
40	50	pn16	150	110	62	4	18	18
50	63	pn16	165	125	78	4	18	18
65	75	pn16	185	145	92	4	18	18
65*	75	pn16	185	145	92	8	18	18
80	90	pn16	200	160	108	8	18	20
100	110	pn16	220	180	128	8	18	20
100*	125	pn16	220	180	135	8	18	20
125	125	pn16	250	210	135	8	18	22
125*	140	pn16	250	210	158	8	18	22
150	160	pn16	285	240	178	8	22	22
150*	180	pn16	285	240	188	8	22	22
200	200	pn16	340	295	235	12	22	24
200*	225	pn16	340	295	238	12	22	24
250	250	pn16	405	355	288	12	26	26
250*	280	pn16	405	355	294	12	26	26
300	315	pn16	460	410	338	12	26	28
350	355	pn16	520	470	376	16	26	30
400	400	pn16	580	525	430	16	30	32

PP Coated Backing Ring ISO7005/EN1092

Material:PP(30% Glass Fiber Reinforced) With Steel Ring
UV-resistant. Applicable for outside applications
Standard:ISO 7005,EN1092,BS 4504,DIN 2501 Unit: mm



DN	PE dn	PN	D	K(PCD)	B(ID)	n	d	h
200	200	pn10	340	295	235	8	22	24
200*	225	pn10	340	295	238	8	22	24
250	250	pn10	395	350	288	12	22	26
250*	280	pn10	395	350	294	12	22	26
300	315	pn10	445	400	338	12	22	26
350	355	pn10	510	460	376	16	22	28
400	400	pn10	570	515	430	16	26	30
400	450	pn10	620	565	517	20	26	32

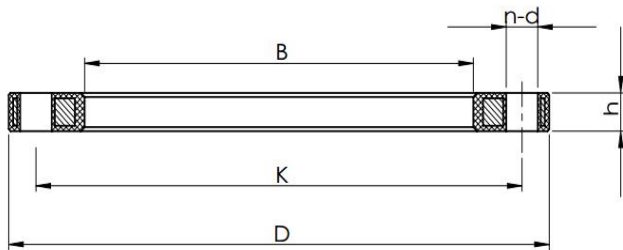



PP Fiber Backing Ring ISO7005/EN1092

It's a new corrosion-free, full plastic, fiber reinforced PP, light weight, reliable, and with long life span. Aim to replace galvanised steel backing ring and the price will be cheaper.

Standard:ISO 7005,EN1092,BS 4504,DIN 2501 Unit: mm
90mm sample available now.

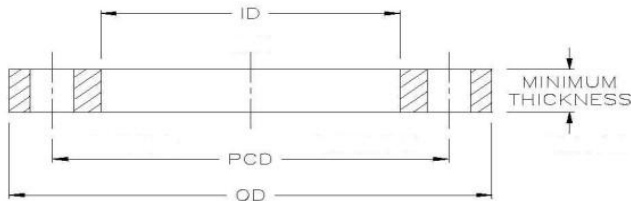

d	DN	PN	OD	PCD	ID	Bol t No.	Bolt Hole Dia	Thickn ess	SC	kg
63	50	16	165	125	78	4	18	24	M16	0.38
75	65	16	185	145	92	4	18	26	M16	0.52
90	80	16	200	160	108	8	18	27	M16	0.57
110	100	16	220	180	128	8	18	28	M16	0.67
125	100	16	220	180	135	8	18	28	M16	0.63
140	125	16	250	210	158	8	18	30	M16	0.86
160	150	16	285	241	178	8	22	32	M20	1.2
180	150	16	285	240	188	8	22	32	M20	1.1
200	200	16	340	296.5	235	8	22	34	M20	1.59
225	200	16	340	296.5	238	8	22	34	M20	1.55
250	250	16	395	350	288	12	22	38	M20	2.13
280	250	16	395	350	294	12	22	38	M20	2.02
315	300	16	445	400	338	12	22	42	M20	2.74

Ductile Iron Backing Ring ISO7005/EN1092

Material: Ductile Iron to ASTM A536 Gr64/45/12

Standard: ISO7005/EN1092/DIN2576

Surface finish : FBE, Painted , Galvanized, Hot-dip Galvanized, Fusion bounded epoxy resin Unit: Inch

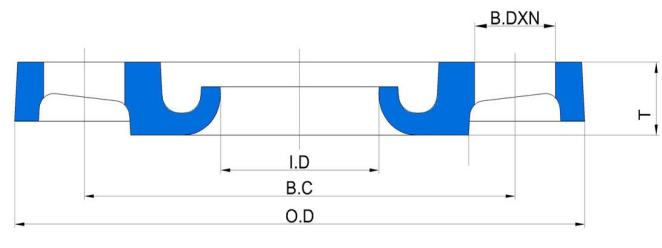

Size	Pressure	OD	ID	T	Bolt No.	Bolt Hole Dia	Bolt Hole Circle	Unit Weight (KG)
						B.D.	B.C.	
DN50/63	pn16/10	78	165	12	4	18	125	0.83
DN65/75	pn16/10	92	185	12	4	18	145	0.99
DN80/90	pn16/10	108	200	13	8	18	160	1.14
DN100/110	pn16/10	128	220	14	8	18	180	1.35
DN150/160	pn16/10	178	285	16	8	22	240	2.07
DN200/200	pn16/10	235	340	18	8	22	295	3.13
DN250/250	pn16/10	288	395	22	12	22	350	4.43
DN300/315	pn16/10	338	445	24	12	22	400	5.81